

Gillespi Business Center

2135 Defoor Hills Road & 2144/48 Hills Ave.
Atlanta, GA 30318

2,606 sf Available
100% Air conditioned Loft Office/Warehouse Space



2144-E Hills Avenue, Atlanta, GA 30318

Features

Located in the Chattahoochee Industrial/Westside Design District. Close to I-75, I-85, Downtown and Buckhead.

100% Air Conditioned
100 amp electrical service, 3-phase
15'6" Ceiling Height
Fully Sprinklered
Covered common dock high and rear loading

Common Expenses: \$2.05 apsf
Base Year Rental Rate: \$11.50 apsf nnn
Annual 3% escalations



MEWS
DEVELOPMENT

404 355 1505 | fax 404 355 3705 | www.mewsdevelopment.com
2135 Defoor Hills Road, Suite K2, Atlanta, GA 30318

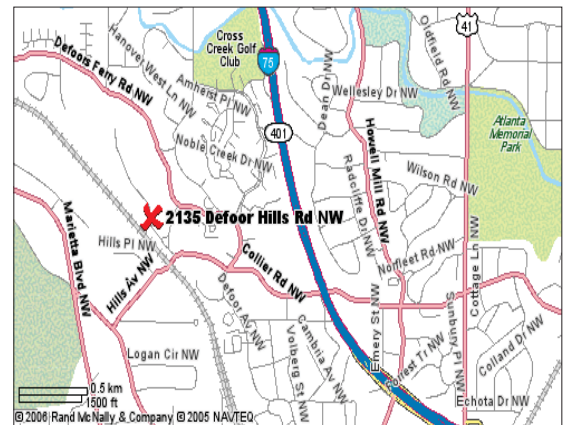

For More Information - Contact:
Anne Puett Johnson
404 355 1505
annepj@mewsdevelopment.com

Deshion Crawford
404 355 1505
deshion@mewsdevelopment.com

Rear covered common drive thru area

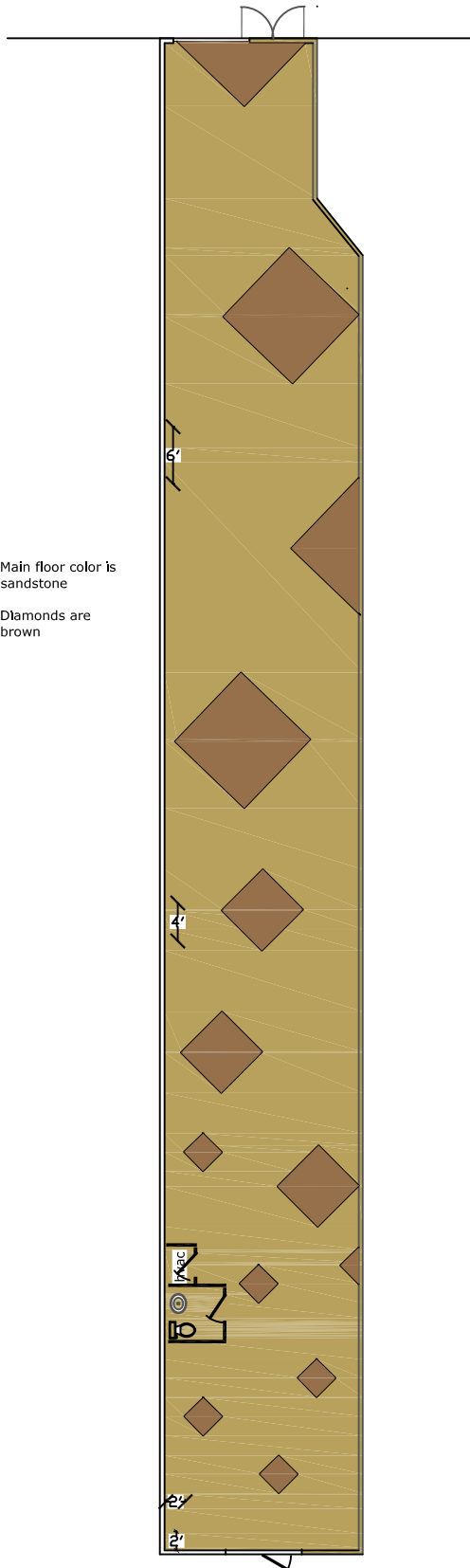

Main floor color is sandstone
Diamonds are brown

2144 Hills Ave.
Suite E
2,606sf
100% Air
Conditioned space

